



**YEAR 12**  
**Induction Day**  
**Thursday 6<sup>th</sup> July 2023**  
**PERIOD 5**

# **Mr Huckle**

## **Associate Principal**

## **Head of Sixth Form**

## TAKING THE NEXT STEP

Raising the participation age to 18. Option Pathways:



Samuel Whitbread  
Sixth Form



College



Apprenticeships

← 20 hours of full time education or training per week →

There are other options as well such as School Leavers Programmes and T Levels.

Please speak to the careers advice team for further guidance if you are still unsure.



Year 13 Results	2022
A*-A	35%
A*-B	70%
A*-C	90%
A*-E	99.8%



A Level Performance  
System (ALPS) grading for  
2022

**3 = Excellent  
Progress**



	2019	2020	2021	2022
% of students successful in gaining a place at a Russell Group University (top 24 research based Universities in the UK)	14%	24%	32%	37%



Destination	Number
University	121
Apprenticeship	30
Seeking apprenticeship	0
Employment/Job	11
Seeking employment	0
College	4
Gap Year	7
Services	1
Repeat year 13	2



BELIEVE • ACHIEVE • SUCCEED • EXCEED

# **Mrs Jackman**

## **Sixth Form Enrichment Co-ordinator**



# Enrichment and Work Experience



If you could study ANYTHING at all, what would it be?

# What is enrichment?



Your opportunity to develop skills and knowledge that sets you apart from other students when you leave

To undertake a project or experience something outside your ALevel subjects

A chance to 'give back' to your community or school

**Every 6<sup>th</sup> form student at SWA completes one enrichment in year 12**

# Enrichment Options



Rugby  
Netball  
Football  
Maths/ English retake  
(timetabled), Further Maths  
Mathematical studies  
EPQ

- The Society
- Eco Committee
- T4T
- MOOC's
- NCS
- DofE
- Subject Ambassadors
- Youth Ambassadors
- Wrest Park volunteering
- Plus others

# EPQ



- Worth half an A Level
- 3 hours per fortnight timetabled
- 5000 word essay or product +1000 essay
- Logbook (diary)
- Pick anything you want to research
- Focus is on skills development e.g. analysis, independent learning, research, time management
- Some Universities make alternative offers and/ or grants

- “What impact did the one child policy have on women in China?”
- “How important were Blacksmiths in helping ancient Rome thrive and conquer?”
- “Should the US budget include funds for space exploration or should private corporations take on this role?”
- “Is laughter contagious?”

# How to select enrichment?



- Some of you have already selected your enrichment (Rugby, Further Maths etc)
- For everyone else:
  - We will host an enrichment fair in September
  - You must sign up to one enrichment
  - You will then be invited to join the google classroom where all communication will be made/ resources uploaded
  - You will also need to upload resources for some of the courses
  - Enrichment will begin towards the end of September – don't panic if it doesn't start immediately!



# Work Experience



In July, students in year 12 complete one week's work experience. More information will be released in September regarding this but start thinking about where you might like to go.

Popular placements in media, law, museums go quickly so please check when their deadlines are.

Any questions about Enrichment

[RJackman@bestacademies.org.uk](mailto:RJackman@bestacademies.org.uk)



# **Miss Corbishley**

## **Post 16 Aspirations Lead**



# **ASPIRATIONS AND OPPORTUNITIES**

Miss Corbishley  
HPA Inclusion & Diversity Lead

# Post-16 options

The same..... but  
different

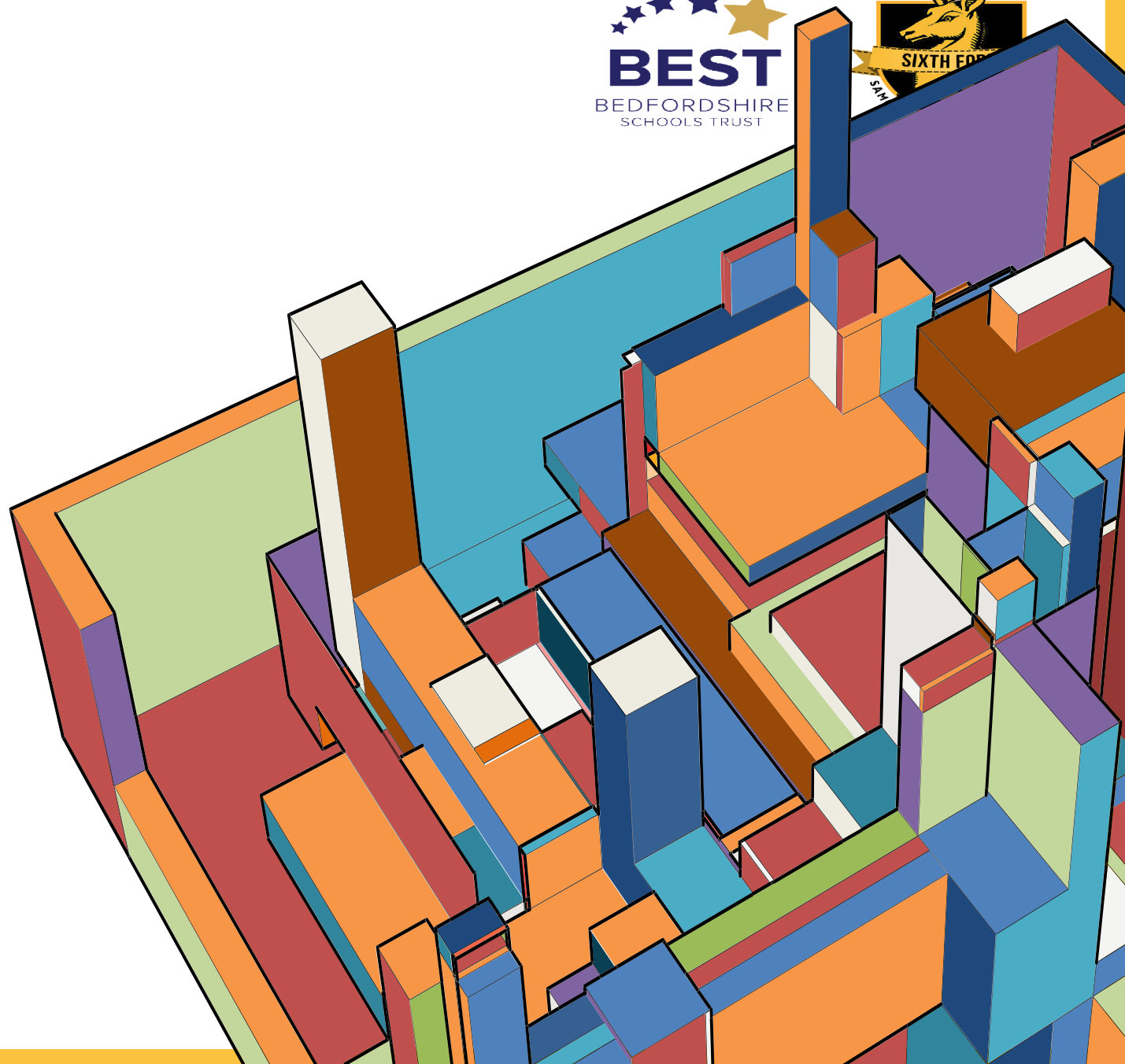



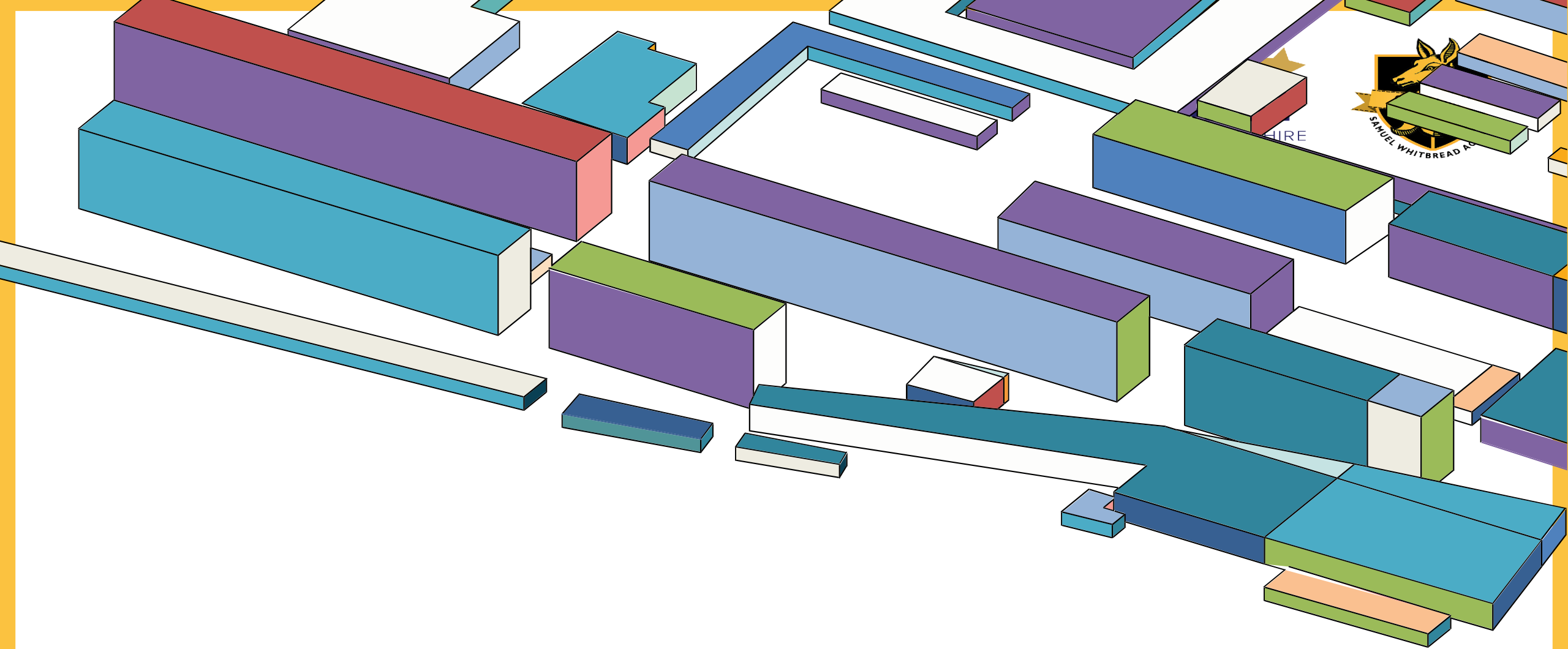

Ways we can help you

# Do any of these apply to you?

You don't need to say it out loud – just have a think to yourself about it

Neither of your parents went to University.

You are a girl who wants to study a STEM subject.

You have no idea what you want to do!

You are from a BAME background.

You live in an area where not many people go on to higher education.

You are entitled to free school meals.

You are a high achiever.

You want to go to Oxbridge.

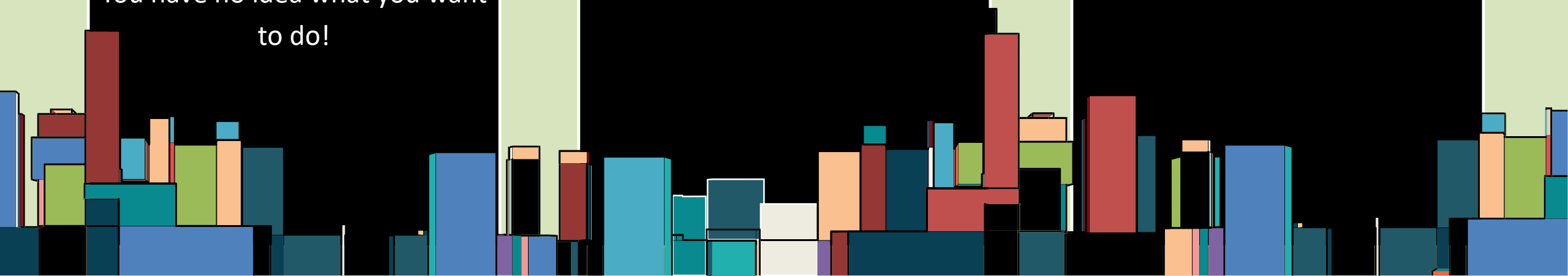

# Do I have to choose now?



University

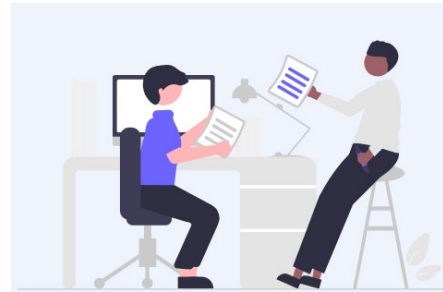

Apprenticeship



Job Market

# University

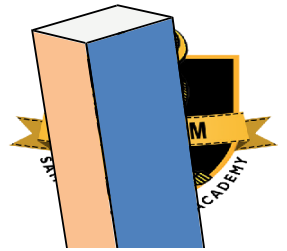

## Exploration



Exploration

### Exploring courses

A short module to help you search for and compare courses effectively.

Start

Exploration

### Exploring FE colleges

A guide to exploring post-18 options at Further Education colleges.

Start

Exploration

### Exploring universities

This module will help you to think about what is important to you when choosing a university and it will guide you through the process of comparing different universities.

Start

Exploration

### Making the most of university events/activities

Are you taking part in any university events this year? Here's a quick guide to making the most out of these opportunities so that you can include them in an effective way in your university application.

Start

Exploration

### Nursing and Midwifery introduction

This module provides an introduction to the main types of Nursing and Midwifery courses.

Start

Exploration

### Student Finance

An introduction to student finance, including student loans, paying back student loans, bursaries and scholarships.

Start

Exploration

### Understanding the UCAS Application Process

This module will guide you through an introduction to the UCAS process. It will look at key dates and help you to start thinking about the different elements that make up an application.

Start

# Apprenticeships

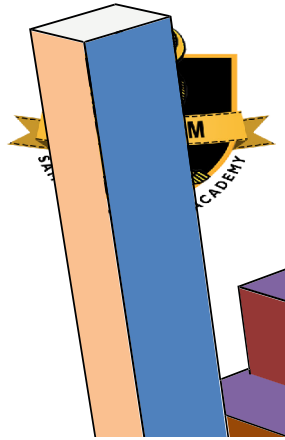

## Apprenticeships



### Apprenticeships

#### 1. Understanding Apprenticeships

This is the first of 3 modules which will help you understand what apprenticeships are and how to work which level is best for you.

Start

### Apprenticeships

#### 2. Preparing an Apprenticeship application

Following on from the first Apprenticeships module - this module will help you understand what an Apprenticeship application is, how you can register for an apprenticeship and where you can find vacancies.

Start

### Apprenticeships

#### 3. Making an Apprenticeship application

The final Apprenticeship module will take you step by step through the apprenticeship application document.

Start

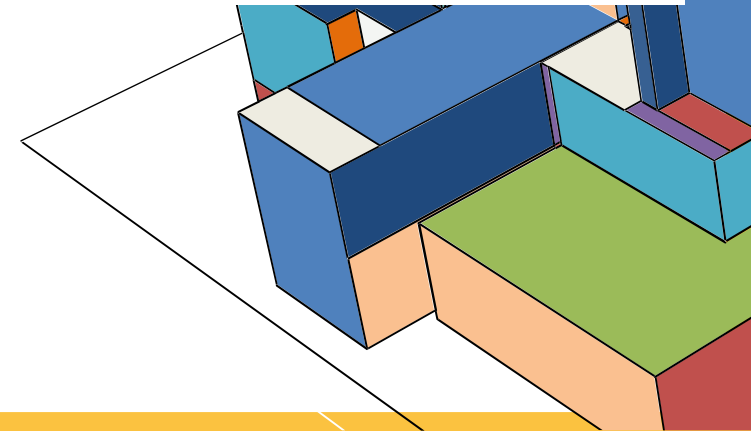



# Job Market

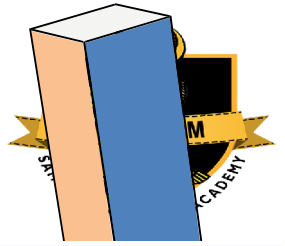

## Other Experiences



### Other Experiences

#### Commercial Awareness

This task is designed to give you an overview of commercial awareness. It looks at how you can develop your own commercial awareness before attending a work experience placement.

[Start](#)

### Other Experiences

#### Developing Your Personal Impact for Work Experience

This module guides you through how to understand and effect the personal impact you have on others, especially those you meet in a working environment.

[Start](#)

### Other Experiences

#### Medical Work Experience (Caring Placements)

A guide to identifying, preparing for and making the most of medical work experience. This module focuses on caring placements specifically.

[Start](#)

### Other Experiences

#### Medical Work Experience (Shadowing a Doctor)

A guide to identifying, preparing for and making the most of medical work experience. This module focuses on shadowing placements specifically.

[Start](#)

### Other Experiences

#### Professionalism for Work Experience

This module guides you through how to understand what is expected of you whilst on work experience and how to act professionally.

[Start](#)

### Other Experiences

#### Video interviews

In this module you will learn how to approach video interviews. We will look at how to prepare and how to gain the most from the experience.

[Start](#)

### Other Experiences

#### Work experience (non-medical)

A guide to identifying, preparing for and making the most of your work experience placement.

[Start](#)

# OXBridge & the Russell group

24 leading  
UK  
universities

World-class  
research &  
education

Oxford *or*  
Cambridge



University of Birmingham

University of Bristol

B

University of Cambridge

Cardiff University

Durham University

University of Edinburgh

University of Exeter

University of Glasgow

Imperial College London

King's College London

University of Leeds

University of Liverpool

London School of Economics  
and Political Science

University of Manchester

Newcastle University

University of Nottingham

University of Oxford

Queen Mary University of London

Queen's University Belfast

University of Sheffield

University of Southampton

University College London

University of Warwick

University of York

# How to stand out



- EPQ
- NCS – National Citizenship Service
- MOOC's – this is the big area from this year onwards – showing independent learning and passion!
- DofE
- Volunteering
- Work experience
- Subject ambassadors
- Study days at universities
- Student leadership team
- Prefect
- Any other enrichment activity you have completed
- The Society membership and involvement
- Tutorial attendance
- Committee involvement/Society involvement

# FAST-TRACK YOUR CAREER

with a microcredential

Get accredited with a professional certification  
now - enrolments closing soon!

[Discover courses](#)CIPD

Raspberry Pi

KING'S  
College  
LONDONDEAKIN  
UNIVERSITY

UCL

University  
of GlasgowThe Open  
University

CAMBRIDGE



Health Education England

accentureInstitut  
FRANÇAIS  
de la  
MODE

UNIVERSITY OF LEEDS

BLOOMSBURY

Coventry  
University

Online Courses / Study Skills



# Preparing for University

★★★★☆ 4.7 (47 reviews)

Build the academic skills you need for learning at university and ease your transition from school learning to higher education.

[Join course](#)

80,224 enrolled on this course





# Where can I get more help?



- UCAS survival guide – emailed to all students
- Form tutor
- Mr Huckle, Mrs Hoad, Mr Tonking
- Mrs Bonham, Miss Collins
- UCAS website
- Year 12 Google Classroom
- Sixth form learning platform on Google Drive

THANK YOU

**Mr Tonking**  
Head of Year 12  
Assistant Head of Sixth Form

reflect



engage

discuss



# How do I change a subject for September?



**swa-sixthformadmissions@  
bestacademies.org.uk**

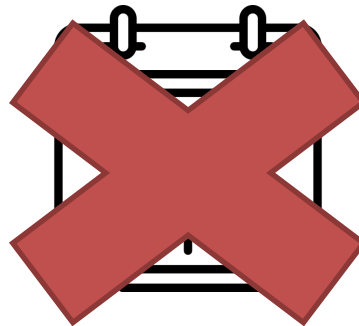

# What if I do not meet the entry requirements for a course?



# What time do I need to be in every day?



**08 : 20**



# When am I allowed to leave school site?

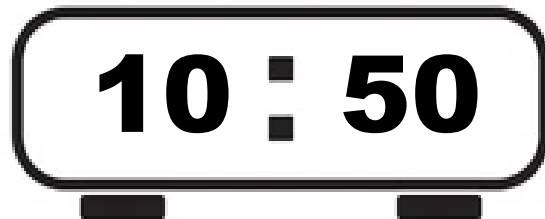

P1	Biology
P2	English
P3	
P4	
P5	History

P1	Biology
P2	English
P3	
P4	
P5	

# Who is my tutor?

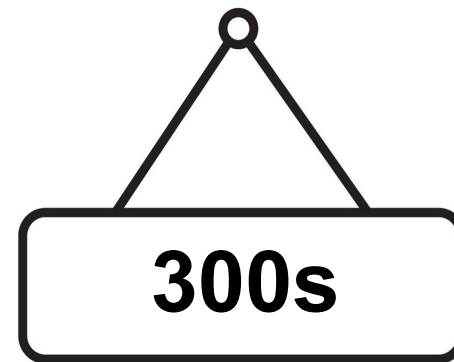

# What will we do in registration?



# What happens if I do not attend a lesson?

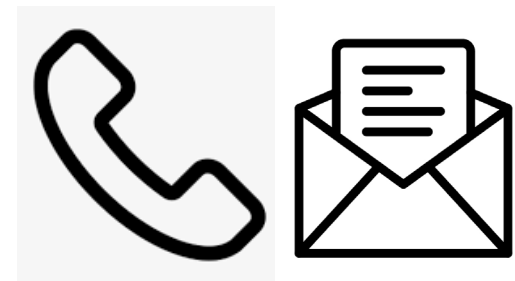

# What should I do when I have a 'free period'?

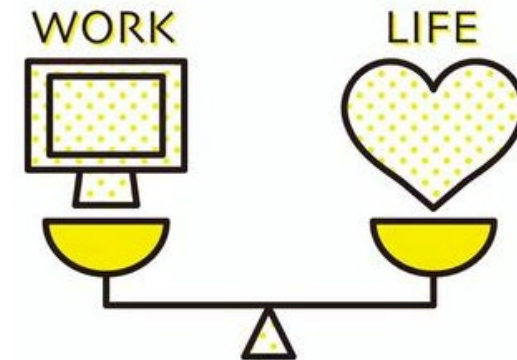

# What is the Sixth Form dress code?



# Why do I need to wear a lanyard everyday?

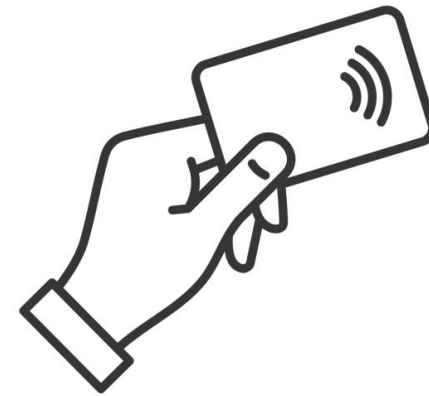

# What do I need to buy ready for September?





**What else should I be doing  
this summer to prepare for  
SWA?**

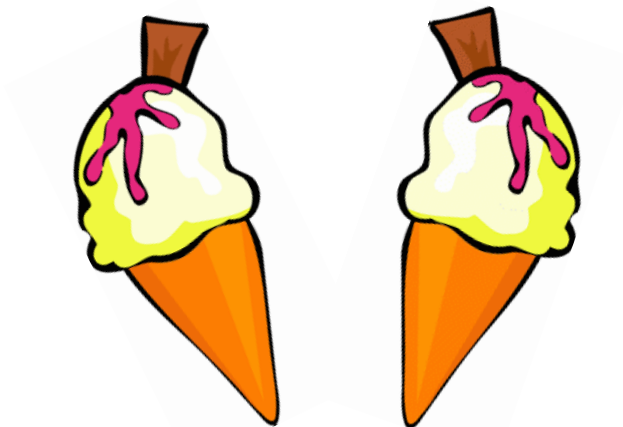

# Thank you & Good Luck



**swa-sixthformadmissions@  
bestacademies.org.uk**



**ctonking@  
bestacademies.org.uk**



**lhuckle@  
bestacademies.org.uk**



**cbonham@  
bestacademies.org.uk**